

CONTENTS INCLUDE:

- A = 2 x Rotary Drums
- B = 2 x Support Frames
- C = 1 x Axle Frame
- D = 1 x Centre Manifold (RM007-HRM4)
- E = 1 x Outlet Connector with Washer (RM004)
- F = 2 x Spacers (RM014)
- G = 1 x Inlet Connector with Washer (BHA-TA34)
- H = 1 x Rotary Drum Joiner (RM006)
- I = 1 x Rewind Handle (RM008)
- J = 2 x Pairs Frame Clamps (RM010)
- K = 1 x M6 Bolt & Nut
- L = 10 x M4 Nuts & Bolts
- M = 2 x Wheels and Fittings (RM013)
- N = 2 x Spring Clips (RM002)
- O = 2 x Hub Caps (RM005)

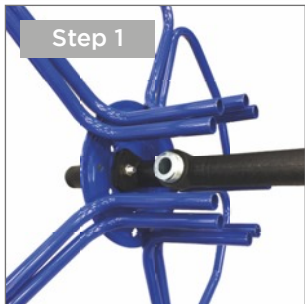

Step 1: Slide centre manifold (D) through rotary drum (A) and attach using M6 bolt & nut fixing (K).

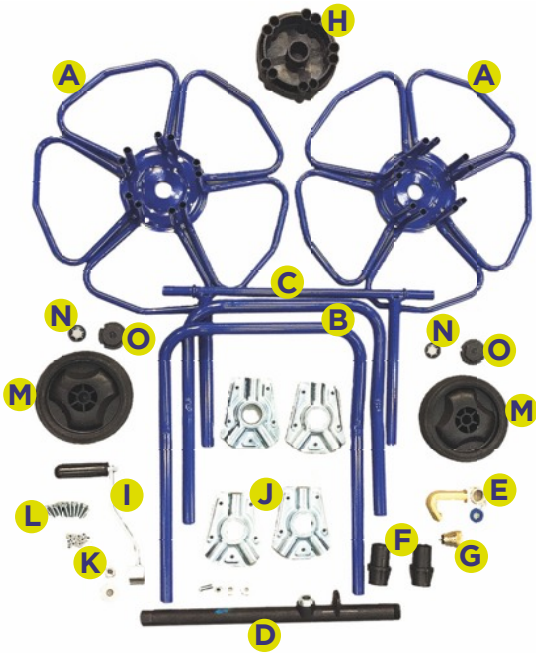
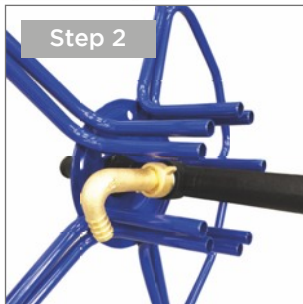

Step 2: Attach outlet elbow (E) to centre manifold (D) and tighten, remembering to insert washer behind the flynut.

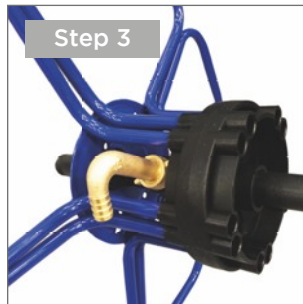

Step 3: Push drum joiner (H) onto rotary drum (A).



Step 4: Push second rotary drum (A) onto the other side of the drum joiner (H).

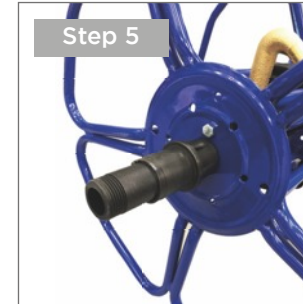

Step 5: Slide the 2 spacers (F) onto the centre manifold (D), one on each side and with the cones facing in towards the rotary drums.

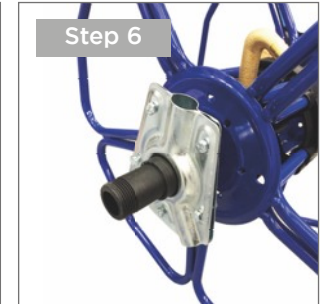

Step 6: Loosely assemble clamps (J) using the M4 bolts & nuts (L), so that the support frames (B) and axle (C) can slide into them. Position them on the shoulders of the spacers (F).



Step 7: Slide support frames (B) and axle (C) into clamps (J) and ensure they are pushed all the way into position, then tighten all bolts & nuts.

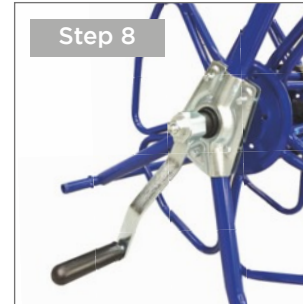

Step 8: Fit rewind handle (I) onto the one side and brass inlet connector (G) onto the other side of the centre manifold (D).



Step 9: Position wheels (M) onto axle and gently hammer spring clips (N), one each side of reel, onto the axle, clips facing outwards, until wheels are held securely with no lateral movement.



Step 10: Push hub caps (O) into place, to cover spring clips.